

**M54 to M6 Link Road**  
**TR010054**  
**Volume 2**  
**2.5 General Arrangement Plans**

Regulation 5(2)(o)

Planning Act 2008

Infrastructure Planning (Applications: Prescribed  
Forms and Procedure) Regulations 2009

October 2020

Infrastructure Planning

Planning Act 2008

**The Infrastructure Planning  
(Applications: Prescribed Forms and  
Procedure) Regulations 2009**

**M54 to M6 Link Road  
Development Consent Order 202[ ]**

---

**General Arrangement Plans**

---

<b>Regulation Number</b>	Regulation 5(2)(o)
<b>Planning Inspectorate Scheme Reference</b>	TR010054
<b>Application Document Reference</b>	2.5
<b>Author</b>	M54 to M6 Link Road Project Team and Highways England

<b>Version</b>	<b>Date</b>	<b>Status of Version</b>
P03	October 2020	Update due to Proposed Scheme Changes October 2020

## Schedule of Plans included in this Application Document

Drawing Number	Drawing Title	Revision
HE514465-ACM-HGN-M54_SW_PR_Z-DR-CH-1001	GENERAL ARRANGEMENT REGULATION 5(2)(O) KEY SHEET	P15
HE514465-ACM-HGN-Z1_SW_PR_Z-DR-CH-1001	GENERAL ARRANGEMENT REGULATION 5(2)(O) SHEET 1 OF 10	P11
HE514465-ACM-HGN-Z1_SW_PR_Z-DR-CH-1002	GENERAL ARRANGEMENT REGULATION 5(2)(O) SHEET 2 OF 10	P09
HE514465-ACM-HGN-Z1_SW_PR_Z-DR-CH-1003	GENERAL ARRANGEMENT REGULATION 5(2)(O) SHEET 3 OF 10	P10
HE514465-ACM-HGN-Z1_SW_PR_Z-DR-CH-1004	GENERAL ARRANGEMENT REGULATION 5(2)(O) SHEET 4 OF 10	P10
HE514465-ACM-HGN-Z1_SW_PR_Z-DR-CH-1005	GENERAL ARRANGEMENT REGULATION 5(2)(O) SHEET 5 OF 10	P10
HE514465-ACM-HGN-Z1_SW_PR_Z-DR-CH-1006	GENERAL ARRANGEMENT REGULATION 5(2)(O) SHEET 6 OF 10	P10
HE514465-ACM-HGN-Z1_SW_PR_Z-DR-CH-1007	GENERAL ARRANGEMENT REGULATION 5(2)(O) SHEET 7 OF 10	P09
HE514465-ACM-HGN-Z1_SW_PR_Z-DR-CH-1008	GENERAL ARRANGEMENT REGULATION 5(2)(O) SHEET 8 OF 10	P09
HE514465-ACM-HGN-Z1_SW_PR_Z-DR-CH-1009	GENERAL ARRANGEMENT REGULATION 5(2)(O) SHEET 9 OF 10	P09
HE514465-ACM-HGN-Z1_SW_PR_Z-DR-CH-1010	GENERAL ARRANGEMENT REGULATION 5(2)(O) SHEET 10 OF 10	P09

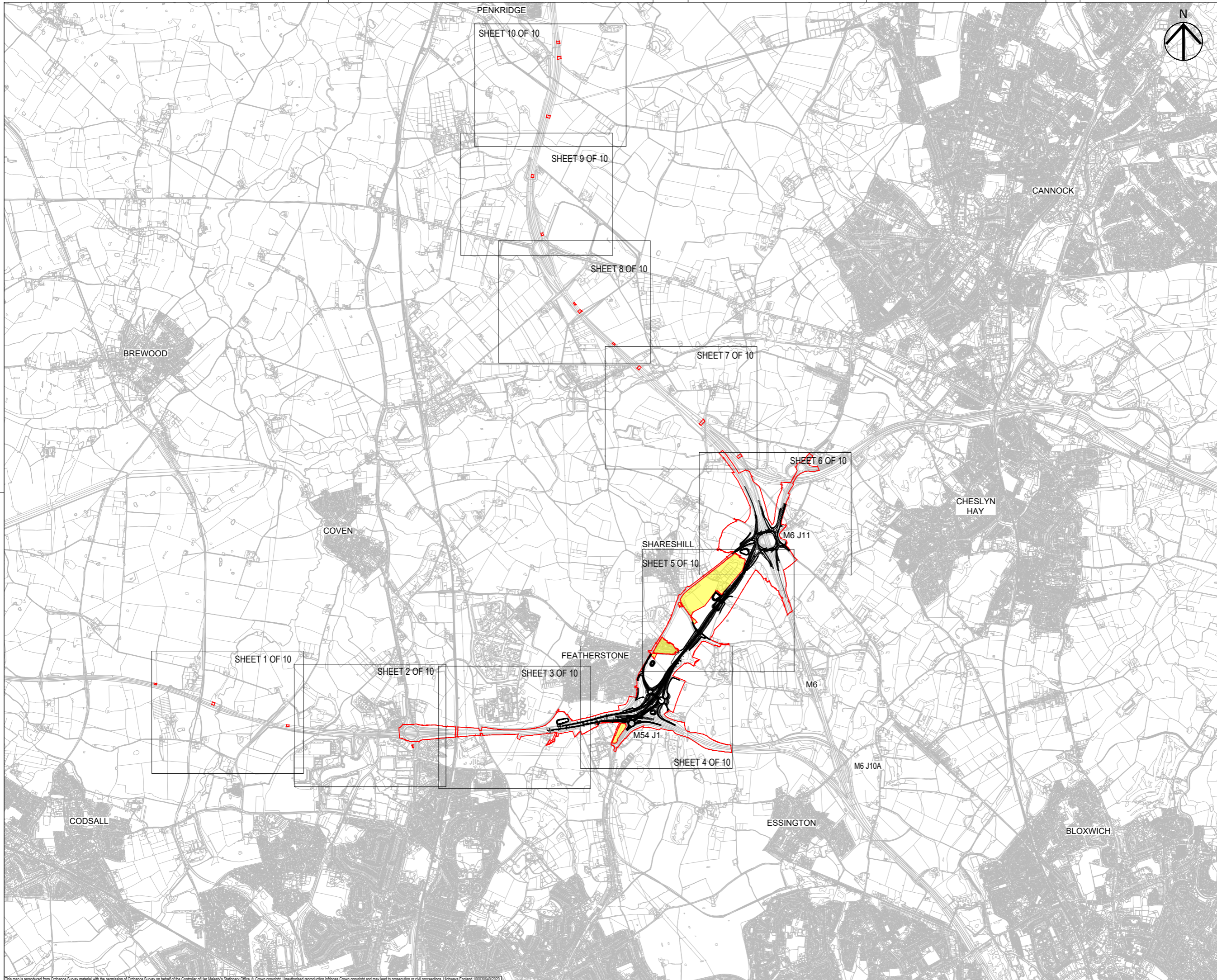

- NOTES**
1. THIS DRAWING IS TO BE READ IN CONJUNCTION WITH ALL OTHER RELEVANT DOCUMENTATION.
  2. DO NOT SCALE FROM THIS DRAWING. USE ONLY PRINTED DIMENSIONS.
  3. ALL DIMENSIONS IN MILLIMETRES. ALL CHAINAGES, LEVELS AND COORDINATES ARE IN METRES UNLESS DEFINED OTHERWISE.
  4. THIS DRAWING IS TO BE READ IN CONJUNCTION WITH THE PROJECT HEALTH & SAFETY FILE FOR ANY IDENTIFIED POTENTIAL RISKS.
  5. THIS PLAN WAS AMENDED IN MAY 2020 TO REMOVE A SMALL AREA OF THE ORDER LIMITS WITHIN THE HIGHWAY BOUNDARY OF THE M54 PREVIOUSLY INCLUDED FOR THE REPLACEMENT OF A ROAD SIGN. THE REPLACEMENT OF THIS SIGN IS NO LONGER REQUIRED. THIS CHANGE MEANS THAT SHROPSHIRE COUNTY COUNCIL IS NO LONGER A HOST AUTHORITY FOR THE SCHEME.

- KEY**
- LIMITS OF LAND TO BE ACQUIRED OR USED PERMANENTLY OR TEMPORARILY (THE ORDER LIMITS)
  - LAND NOT INCLUDED WITHIN THE ORDER LIMITS

Draft Order Limits Updated	AM	AM	12/04/19	P04
Structure B04 Removed. Tower Farm Access Track Added.	MW	AM	29/04/19	P05
Meshes converted to vector hatching for HE graphics	AM	AM	09/05/19	P06
A460 Turning Head Added	AM	AM	10/05/19	P07
Model P05 Release - Refer to sheet 1-10 for updates	MW	DYT	09/09/19	P08
Model P06 Release - Refer to sheet 1-10 for updates. Layout Updated.	AM	RR	11/10/19	P09
RLB updated.	MW	RR	30/10/19	P10
Boarder update and draft stamp removed	JP	DL	20/12/19	P11
Minor amendments.	MW	RR	22/01/20	P12
Sheet 1 Inset 'A' removed.	MW	RR	12/03/20	P13
Note 5 added.	MW	RR	11/05/20	P14
Updated to reflect Oct 2020 scheme changes.	MW	AM	18/09/20	P15
Revision Details	By	Date	Check	Suffix

**DCO APPLICATION**

Client  
Highways England  
Floor 5  
Two Colmore Square  
38 Colmore Circus  
Birmingham  
B4 6BN

Development Consent Order Number  
**TR010054**

Project Title  
**M54 to M6 Link Road**

Development Consent Order Drawing Number  
**TR010054/APP/2.5**

Drawing Title  
**GENERAL ARRANGEMENT  
REGULATION 5(2)(O)  
KEY SHEET**

Designed MW	Drawn MW	Checked AM	Approved AM	Date 18/09/20
Internal Project No. 60536736	Suitability S8			
Scale @ A1 1:200000H/1:200000V	Zone Highways General			

THIS DOCUMENT HAS BEEN PREPARED PURSUANT TO AND SUBJECT TO THE TERMS OF AECOM'S APPOINTMENT BY ITS CLIENT. AECOM ACCEPTS NO LIABILITY FOR ANY USE OF THIS DOCUMENT OTHER THAN BY ITS ORIGINAL CLIENT OR FOLLOWING AECOM'S EXPRESS AGREEMENT TO SUCH USE, AND ONLY FOR THE PURPOSES FOR WHICH IT WAS PREPARED AND PROVIDED.

Drawing Number HE514465	Highways England PIN -ACM	1 Originator -HGN-	1 Volume -DR-CH-1001	Rev P15
Location M54_SW_PR_Z	Type I	Role I	Number I	



- NOTES**
- THIS DRAWING IS TO BE READ IN CONJUNCTION WITH ALL OTHER RELEVANT DOCUMENTATION.
  - DO NOT SCALE FROM THIS DRAWING. USE ONLY PRINTED DIMENSIONS.
  - ALL DIMENSIONS IN MILLIMETRES. ALL CHAINAGES, LEVELS AND COORDINATES ARE IN METRES UNLESS DEFINED OTHERWISE.
  - THIS DRAWING IS TO BE READ IN CONJUNCTION WITH THE PROJECT HEALTH & SAFETY FILE FOR ANY IDENTIFIED POTENTIAL RISKS.
  - THIS PLAN WAS AMENDED IN MAY 2020 TO REMOVE A SMALL AREA OF THE ORDER LIMITS WITHIN THE HIGHWAY BOUNDARY OF THE M54 PREVIOUSLY INCLUDED FOR THE REPLACEMENT OF A ROAD SIGN. THE REPLACEMENT OF THIS SIGN IS NO LONGER REQUIRED. THIS CHANGE MEANS THAT SHROPSHIRE COUNTY COUNCIL IS NO LONGER A HOST AUTHORITY FOR THE SCHEME.

- KEY**
- LIMITS OF LAND TO BE ACQUIRED OR USED PERMANENTLY OR TEMPORARILY (THE ORDER LIMITS)
  - LAND NOT INCLUDED WITHIN THE ORDER LIMITS
  - RETAINING WALLS
  - NON-MOTORISED USER ROUTE (PLEASE REFER TO STREETS, RIGHTS OF WAY AND ACCESS PLANS [TR010054/APP/2.7] FOR MORE INFORMATION)
  - EMBANKMENTS
  - CUTTINGS
  - VERGES / GRASSED AREAS

First Issue in Draft	MW	AM	21/12/18	P01
No significant changes noted from previous revision	JD	AM	22/02/19	P02
No significant changes noted from previous revision	MW	AM	29/03/19	P03
No significant changes noted from previous revision	JP	AM	14/05/19	P04
No significant changes noted from previous revision	MW	AM	15/08/19	P05
Refer to Design Change Tracker for details	JP	DYT	30/10/19	P06
Background colour added	JP	RR	17/12/19	P07
Minor amendments.	MW	RR	21/01/20	P08
Sheet 1 Inset 'A' removed.	MW	RR	12/03/20	P09
Note 5 added.	MW	RR	11/05/20	P10
Hatching and key updated.	MW	RR	08/10/20	P11
Revision Details	By	Check	Date	Suffix

**DCO APPLICATION**

Client  
**Highways England**  
 Floor 5  
 20 Colmore Square  
 20 Colmore Circus  
 Birmingham  
 B4 6BN



Development Consent Order Number  
**TR010054**

Project Title  
**M54 to M6 Link Road**

Development Consent Order Drawing Number  
**TR010054/APP/2.5**

**GENERAL ARRANGEMENT  
 REGULATION 5(2)(O)  
 SHEET 1 OF 10**

Designed	Drawn	Checked	Approved	Date
---	MW	AM	RR	08/10/20
Internal Project No.	Sustainability			
60536736	S8			
Scale @ A1	Zone			
1:2500H/1:2500V	Highways General			

THIS DOCUMENT HAS BEEN PREPARED PURSUANT TO AND SUBJECT TO THE TERMS OF AECOM'S APPOINTMENT BY ITS CLIENT. AECOM ACCEPTS NO LIABILITY FOR ANY USE OF THIS DOCUMENT OTHER THAN BY ITS ORIGINAL CLIENT OR FOLLOWING AECOM'S EXPRESS AGREEMENT TO SUCH USE, AND ONLY FOR THE PURPOSES FOR WHICH IT WAS PREPARED AND PROVIDED.

Drawing Number	Highways England PIN	1 Originator	1 Volume	Rev
<b>HE514465 -ACM</b>	<b>-HGN-</b>			<b>P11</b>
<b>Z1 SW_PR_Z</b>	<b>-DR-CH-1001</b>			
Location	1 Type	1 Role	1 Number	

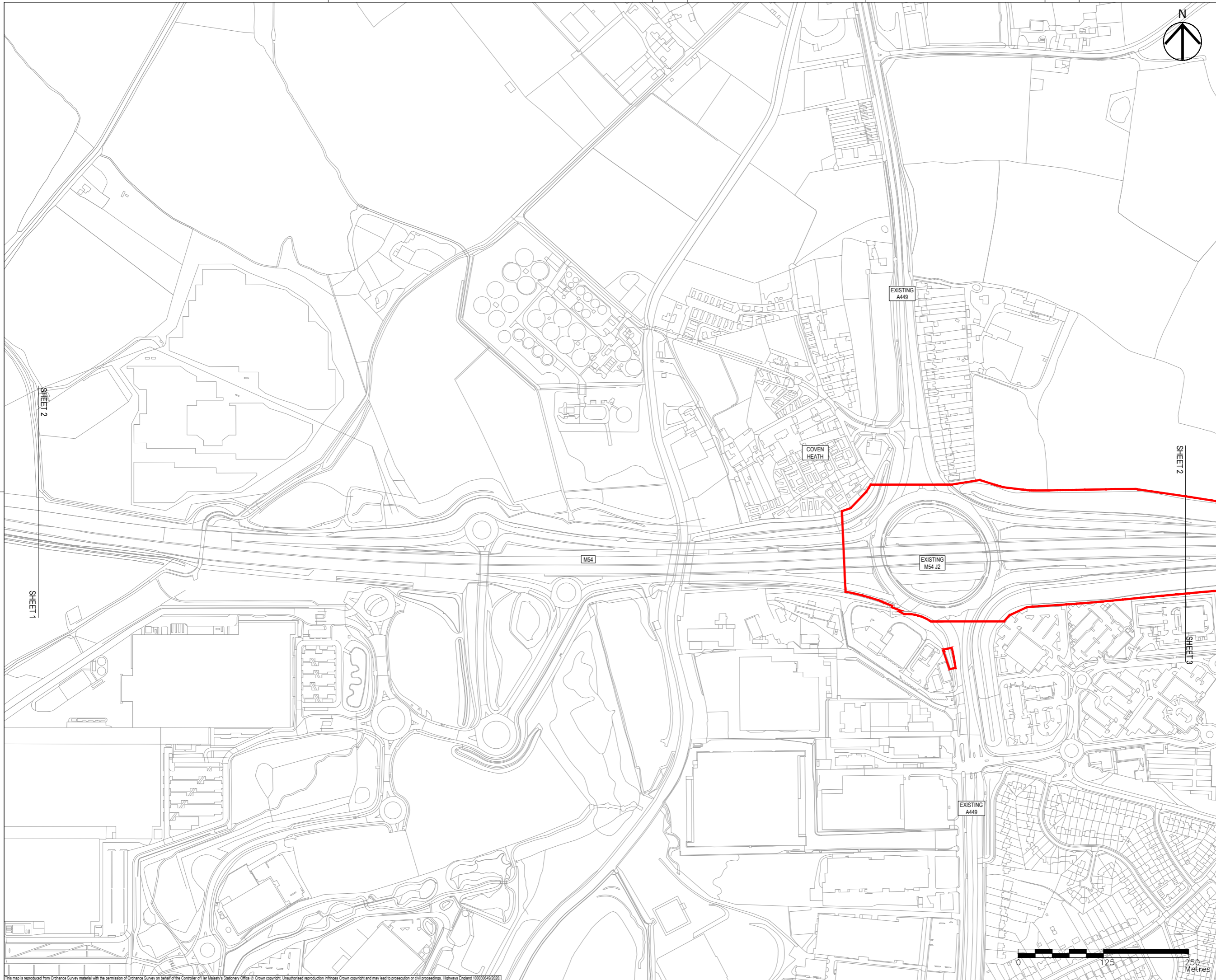

- NOTES**
- THIS DRAWING IS TO BE READ IN CONJUNCTION WITH ALL OTHER RELEVANT DOCUMENTATION.
  - DO NOT SCALE FROM THIS DRAWING. USE ONLY PRINTED DIMENSIONS.
  - ALL DIMENSIONS IN MILLIMETRES. ALL CHAINAGES, LEVELS AND COORDINATES ARE IN METRES UNLESS DEFINED OTHERWISE.
  - THIS DRAWING IS TO BE READ IN CONJUNCTION WITH THE PROJECT HEALTH & SAFETY FILE FOR ANY IDENTIFIED POTENTIAL RISKS.

- KEY**
- LIMITS OF LAND TO BE ACQUIRED OR USED PERMANENTLY OR TEMPORARILY (THE ORDER LIMITS)
  - LAND NOT INCLUDED WITHIN THE ORDER LIMITS
  - RETAINING WALLS
  - NON-MOTORISED USER ROUTE (PLEASE REFER TO STREETS, RIGHTS OF WAY AND ACCESS PLANS [TR010054/APP/2.7] FOR MORE INFORMATION)
  - EMBANKMENTS
  - CUTTINGS
  - VERGES / GRASSED AREAS

First Issue in Draft	MW	AM	21/12/18	P01
See Revision Notes for further details.	JD	AM	22/02/19	P02
No significant changes noted from previous revision	MW	AM	29/03/19	P03
No significant changes noted from previous revision	JP	AM	14/05/19	P04
Refer to Design Change Tracker for details	HS	DYT	15/08/19	P05
Refer to Design Change Tracker for details	JP	RR	30/10/19	P06
Background colour added	JP	DL	17/12/19	P07
Minor amendments.	MW	RR	21/01/20	P08
Hatching and key updated.	MW	RR	08/10/20	P09
Revision Details	By	Check	Date	Suffix

**DCO APPLICATION**

Client  
 Highways England  
 Floor 5  
 Two Colmore Square  
 38 Colmore Circus  
 Birmingham  
 B4 6BN

Development Consent Order Number  
**TR010054**

Project Title  
**M54 to M6 Link Road**

Development Consent Order Drawing Number  
**TR010054/APP/2.5**

Drawing Title  
**GENERAL ARRANGEMENT  
 REGULATION 5(2)(O)  
 SHEET 2 OF 10**

Designed	Drawn	Checked	Approved	Date
---	MW	AM	RR	08/10/20
Internal Project No.	Sustainability			
60536736	S8			
Scale @ A1	Zone			
1:2500H/1:2500V	Highways General			

THIS DOCUMENT HAS BEEN PREPARED PURSUANT TO AND SUBJECT TO THE TERMS OF AECOM'S APPOINTMENT BY ITS CLIENT. AECOM ACCEPTS NO LIABILITY FOR ANY USE OF THIS DOCUMENT OTHER THAN BY ITS ORIGINAL CLIENT OR FOLLOWING AECOM'S EXPRESS AGREEMENT TO SUCH USE, AND ONLY FOR THE PURPOSES FOR WHICH IT WAS PREPARED AND PROVIDED.

Drawing Number	Highways England PIN	1 Originator	1 Volume	Rev
HE514465	-ACM	-HGN-		P09
Z1 SW_PR_Z		-DR-CH-1002		
Location	I Type	I Role	I Number	



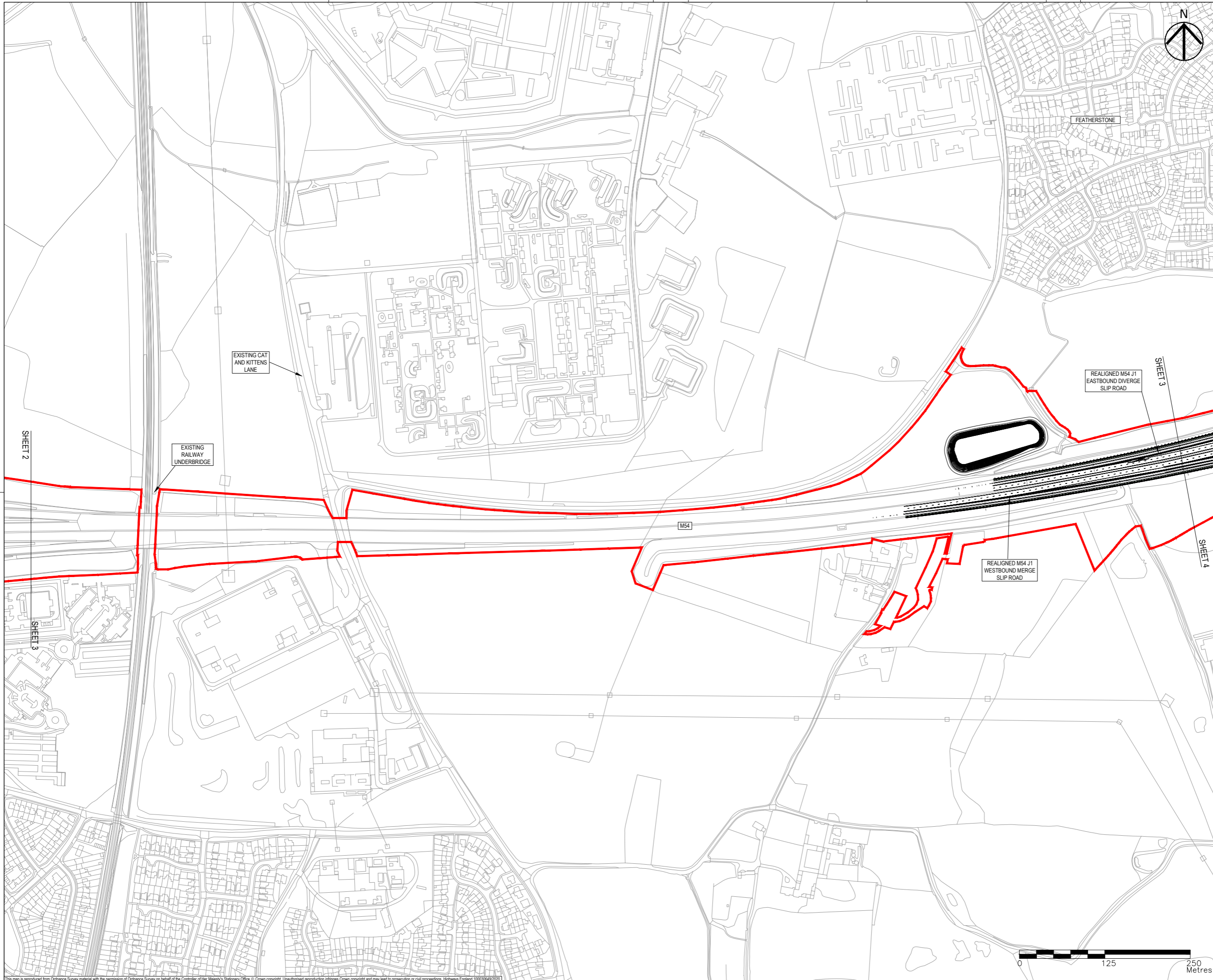

- NOTES**
1. THIS DRAWING IS TO BE READ IN CONJUNCTION WITH ALL OTHER RELEVANT DOCUMENTATION.
  2. DO NOT SCALE FROM THIS DRAWING. USE ONLY PRINTED DIMENSIONS.
  3. ALL DIMENSIONS IN MILLIMETRES. ALL CHAINAGES, LEVELS AND COORDINATES ARE IN METRES UNLESS DEFINED OTHERWISE.
  4. THIS DRAWING IS TO BE READ IN CONJUNCTION WITH THE PROJECT HEALTH & SAFETY FILE FOR ANY IDENTIFIED POTENTIAL RISKS.

- KEY**
- LIMITS OF LAND TO BE ACQUIRED OR USED PERMANENTLY OR TEMPORARILY (THE ORDER LIMITS)
  - LAND NOT INCLUDED WITHIN THE ORDER LIMITS
  - RETAINING WALLS
  - NON-MOTORISED USER ROUTE (PLEASE REFER TO STREETS, RIGHTS OF WAY AND ACCESS PLANS [TR010054/APP/2.7] FOR MORE INFORMATION)
  - EMBANKMENTS
  - CUTTINGS
  - VERGES / GRASSED AREAS

EXISTING CAT AND KITTENS LANE

EXISTING RAILWAY UNDERBRIDGE

REALIGNED M54 J1 EASTBOUND DIVERGE SLIP ROAD

REALIGNED M54 J1 WESTBOUND MERGE SLIP ROAD

SHEET 2

SHEET 3

SHEET 3

SHEET 4

Revision Details	By	Check	Date	Suffix
First Issue in Draft	MW	AM	21/12/18	P01
See Revision Notes for further details.	JD	AM	22/02/19	P02
See Revision Notes for further details.	MW	AM	29/03/19	P03
A460 Turning Head Added. Road Markings and Hatching Added.	AM	AM	10/05/19	P04
Refer to Design Change Tracker for details	HS	DYT	15/08/19	P05
Refer to Design Change Tracker for details	JP	RR	30/10/19	P06
Background colour added	JP	DL	17/12/19	P07
Minor amendments.	MW	RR	21/01/20	P08
Updated to reflect Oct 2020 scheme changes.	MW	AM	18/09/20	P09
Hatching and key updated.	MW	RR	08/10/20	P10

**DCO APPLICATION**

Client  
Highways England  
Floor 5  
Two Colmore Square  
38 Colmore Circus  
Birmingham  
B4 6BN

Development Consent Order Number  
**TR010054**

Project Title  
**M54 to M6 Link Road**

Development Consent Order Drawing Number  
**TR010054/APP/2.5**

Drawing Title  
**GENERAL ARRANGEMENT REGULATION 5(2)(O) SHEET 3 OF 10**

Designed	Drawn	Checked	Approved	Date
---	MW	AM	RR	08/10/20

Internal Project No. 60536736  
Scale @ A1 1:2500H/1:2500V  
Sustainability S8  
Zone Highways General

THIS DOCUMENT HAS BEEN PREPARED PURSUANT TO AND SUBJECT TO THE TERMS OF AECOM'S APPOINTMENT BY ITS CLIENT. AECOM ACCEPTS NO LIABILITY FOR ANY USE OF THIS DOCUMENT OTHER THAN BY ITS ORIGINAL CLIENT OR FOLLOWING AECOM'S EXPRESS AGREEMENT TO SUCH USE, AND ONLY FOR THE PURPOSES FOR WHICH IT WAS PREPARED AND PROVIDED.

Drawing Number  
Highways England PIN  
**HE514465 -ACM -HGN- Z1 SW\_PR\_Z**

1 Originator  
1 Volume  
**-DR-CH-1003**

Rev  
**P10**

Location  
1 Type 1 Role 1 Number

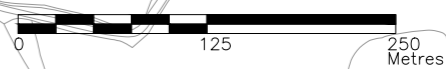

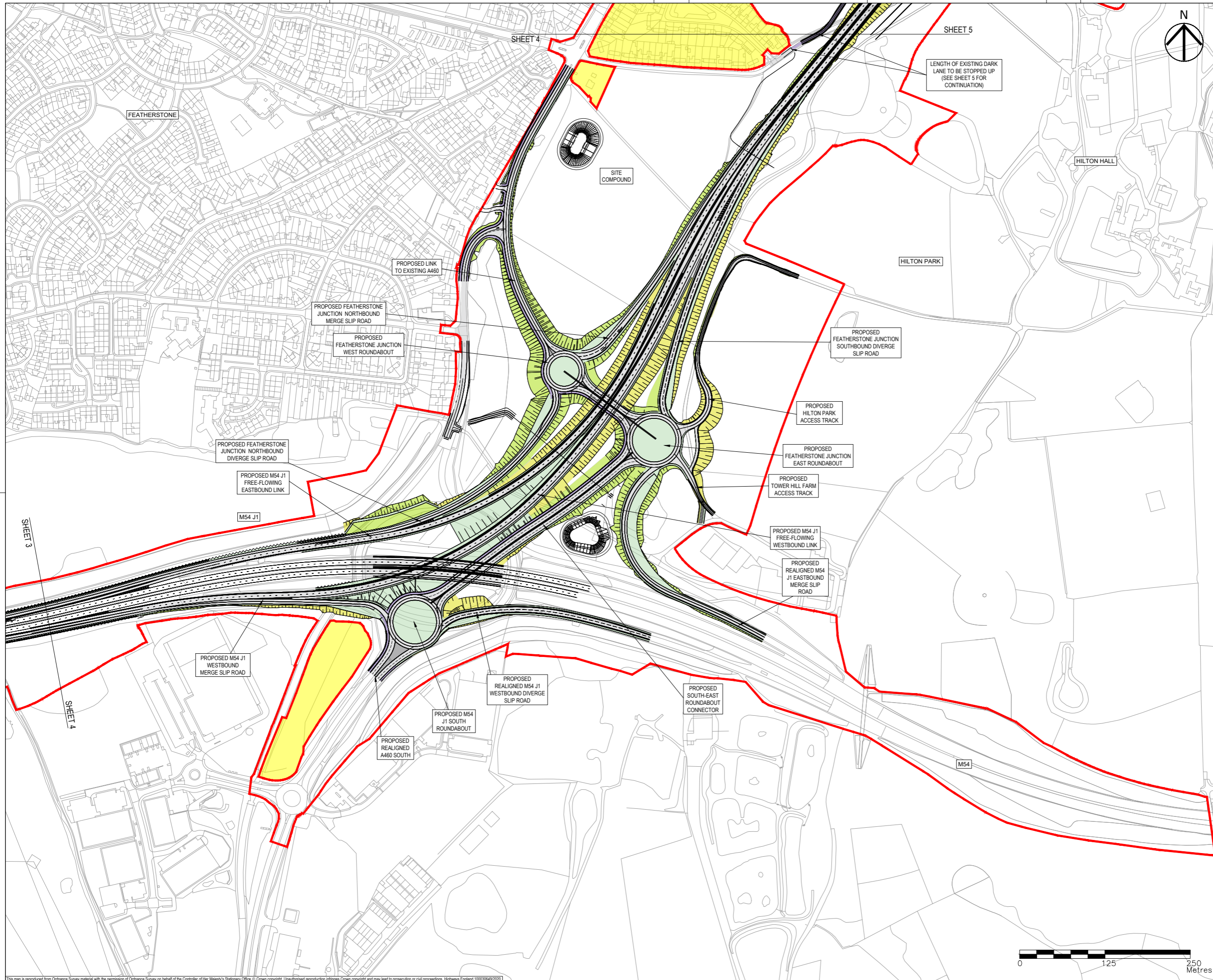

- NOTES**
1. THIS DRAWING IS TO BE READ IN CONJUNCTION WITH ALL OTHER RELEVANT DOCUMENTATION.
  2. DO NOT SCALE FROM THIS DRAWING. USE ONLY PRINTED DIMENSIONS.
  3. ALL DIMENSIONS IN MILLIMETRES. ALL CHAINAGES, LEVELS AND COORDINATES ARE IN METRES UNLESS DEFINED OTHERWISE.
  4. THIS DRAWING IS TO BE READ IN CONJUNCTION WITH THE PROJECT HEALTH & SAFETY FILE FOR ANY IDENTIFIED POTENTIAL RISKS.

- KEY**
- LIMITS OF LAND TO BE ACQUIRED OR USED PERMANENTLY OR TEMPORARILY (THE ORDER LIMITS)
  - LAND NOT INCLUDED WITHIN THE ORDER LIMITS
  - RETAINING WALLS
  - NON-MOTORISED USER ROUTE (PLEASE REFER TO STREETS, RIGHTS OF WAY AND ACCESS PLANS [TR010054/APP/2.7] FOR MORE INFORMATION)
  - EMBANKMENTS
  - CUTTINGS
  - VERGES / GRASSED AREAS

Revision	By	Check	Date	Suffix
First Issue in Draft	MW	AM	21/12/18	P01
See Revision Notes for further details	JD	AM	22/02/19	P02
No significant changes noted from previous revision	MW	AM	29/03/19	P03
No significant changes noted from previous revision	JP	AM	14/05/19	P04
No significant changes noted from previous revision	HS	DYT	15/08/19	P05
Refer to Design Change Tracker for details	JP	RR	30/10/19	P06
Background colour added	JP	DL	17/12/19	P07
Minor amendments	MW	RR	21/01/20	P08
Updated to reflect Oct 2020 scheme changes	MW	AM	18/09/20	P09
Hatching and key updated	MW	RR	08/10/20	P10

**DCO APPLICATION**

Client  
Highways England  
Floor 5  
Two Colmore Square  
38 Colmore Circus  
Birmingham  
B4 6BN

Development Consent Order Number  
**TR010054**

Project Title  
**M54 to M6 Link Road**

Development Consent Order Drawing Number  
**TR010054/APP/2.5**

Drawing Title  
**GENERAL ARRANGEMENT  
REGULATION 5(2)(O)  
SHEET 4 OF 10**

Designed	Drawn	Checked	Approved	Date
---	MW	AM	RR	08/10/20
Internal Project No. 60536736	Sutability S8			
Scale @ A1 1:2500H/1:2500V	Zone Highways General			
THIS DOCUMENT HAS BEEN PREPARED PURSUANT TO AND SUBJECT TO THE TERMS OF AECOM'S APPOINTMENT BY ITS CLIENT. AECOM ACCEPTS NO LIABILITY FOR ANY USE OF THIS DOCUMENT OTHER THAN BY ITS ORIGINAL CLIENT OR FOLLOWING AECOM'S EXPRESS AGREEMENT TO SUCH USE, AND ONLY FOR THE PURPOSES FOR WHICH IT WAS PREPARED AND PROVIDED.				
Drawing Number HE514465 -ACM	Originator -HGN-	Volume Z1_SW_PR_Z	Revision -DR-CH-1004	Rev P10

This map is reproduced from Ordnance Survey material with the permission of Ordnance Survey on behalf of the Controller of Her Majesty's Stationery Office © Crown copyright. Unauthorised reproduction infringes Crown copyright and may lead to prosecution or civil proceedings. Highways England 100030649/2020



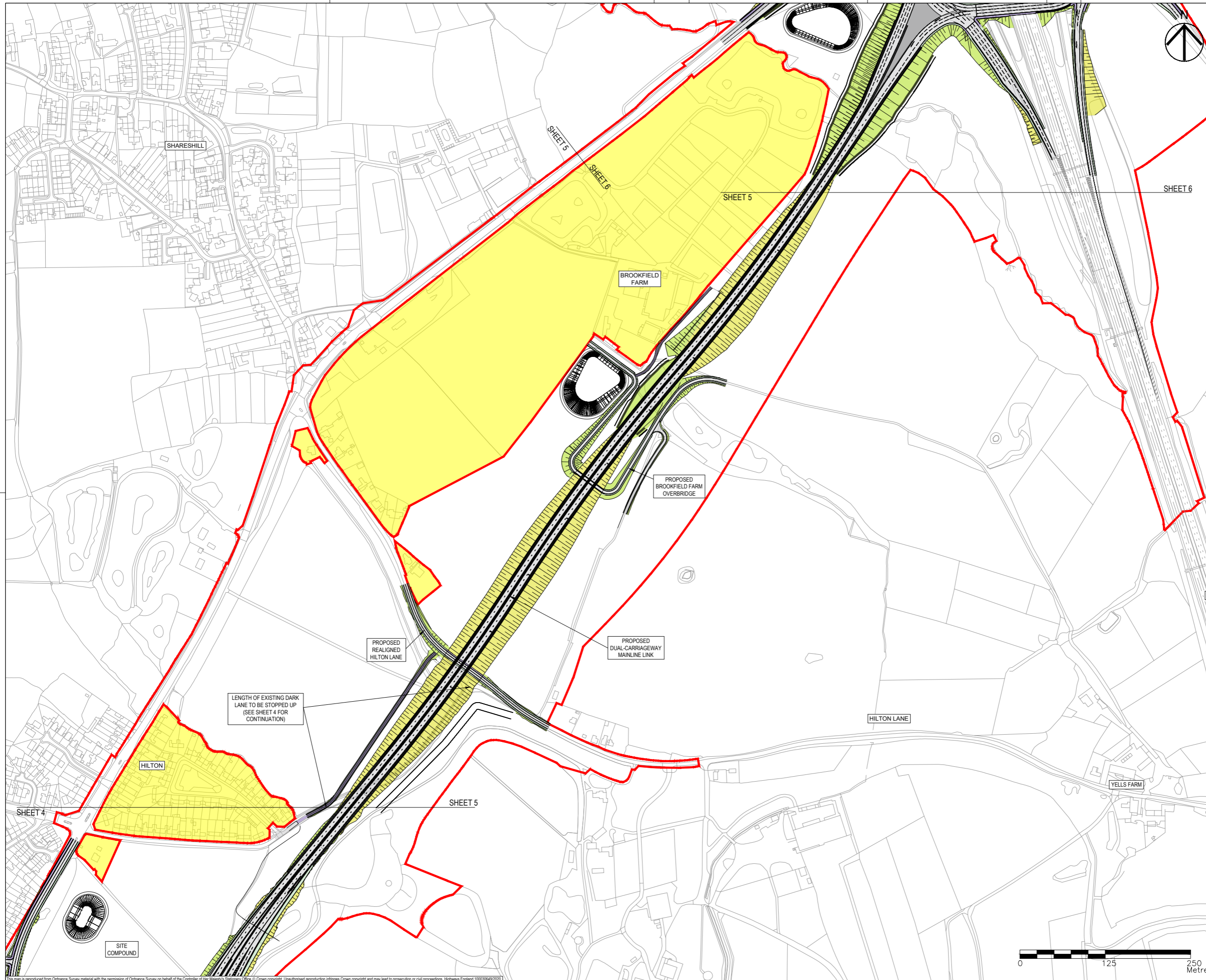

- NOTES**
1. THIS DRAWING IS TO BE READ IN CONJUNCTION WITH ALL OTHER RELEVANT DOCUMENTATION.
  2. DO NOT SCALE FROM THIS DRAWING. USE ONLY PRINTED DIMENSIONS.
  3. ALL DIMENSIONS IN MILLIMETRES. ALL CHAINAGES, LEVELS AND COORDINATES ARE IN METRES UNLESS DEFINED OTHERWISE.
  4. THIS DRAWING IS TO BE READ IN CONJUNCTION WITH THE PROJECT HEALTH & SAFETY FILE FOR ANY IDENTIFIED POTENTIAL RISKS.

- KEY**
- LIMITS OF LAND TO BE ACQUIRED OR USED PERMANENTLY OR TEMPORARILY (THE ORDER LIMITS)
  - LAND NOT INCLUDED WITHIN THE ORDER LIMITS
  - ~ RETAINING WALLS
  - NON-MOTORISED USER ROUTE (PLEASE REFER TO STREETS, RIGHTS OF WAY AND ACCESS PLANS [TR010054/APP/2.7] FOR MORE INFORMATION)
  - EMBANKMENTS
  - CUTTINGS
  - VERGES / GRASSED AREAS

Revision	By	Check	Date	Suffix
First Issue in Draft	MW	AM	21/12/18	P01
No significant changes noted from previous revision	JD	AM	22/02/19	P02
See Revision Notes for further details.	MW	AM	29/03/19	P03
Tower Farm Acc Bridge Removed	AM	AM	10/05/19	P04
Refer to Design Change Tracker for details	HS	DYT	15/08/19	P05
Refer to Design Change Tracker for details	JP	RR	30/10/19	P06
Background colour added	JP	DL	17/12/19	P07
Minor amendments.	MW	RR	21/01/20	P08
Updated to reflect Oct 2020 scheme changes.	MW	AM	18/09/20	P09
Hatching and key updated.	MW	RR	08/10/20	P10

**DCO APPLICATION**

Client  
 Highways England  
 Floor 5  
 Two Colmore Square  
 38 Colmore Circus  
 Birmingham  
 B4 6BN

Development Consent Order Number  
**TR010054**

Project Title  
**M54 to M6 Link Road**

Development Consent Order Drawing Number  
**TR010054/APP/2.5**

Drawing Title  
**GENERAL ARRANGEMENT  
 REGULATION 5(2)(O)  
 SHEET 5 OF 10**

Designed	Drawn	Checked	Approved	Date
---	MW	AM	RR	08/10/20

Internal Project No.  
60536736

Scale @ A1  
1:2500H/1:2500V

Highways General

THIS DOCUMENT HAS BEEN PREPARED PURSUANT TO AND SUBJECT TO THE TERMS OF AECOM'S APPOINTMENT BY ITS CLIENT. AECOM ACCEPTS NO LIABILITY FOR ANY USE OF THIS DOCUMENT OTHER THAN BY ITS ORIGINAL CLIENT OR FOLLOWING AECOM'S EXPRESS AGREEMENT TO SUCH USE, AND ONLY FOR THE PURPOSES FOR WHICH IT WAS PREPARED AND PROVIDED.

Drawing Number	Highways England PIN	Originator	Volume	Rev
HE514465	-ACM	-HGN-		P10
Z2 SW_PR_Z		-DR-CH-1005		

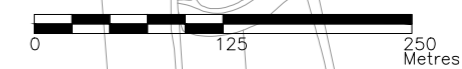

This map is reproduced from Ordnance Survey material with the permission of Ordnance Survey on behalf of the Controller of Her Majesty's Stationery Office © Crown copyright. Unauthorised reproduction infringes Crown copyright and may lead to prosecution or civil proceedings. Highways England 100030649/2020.

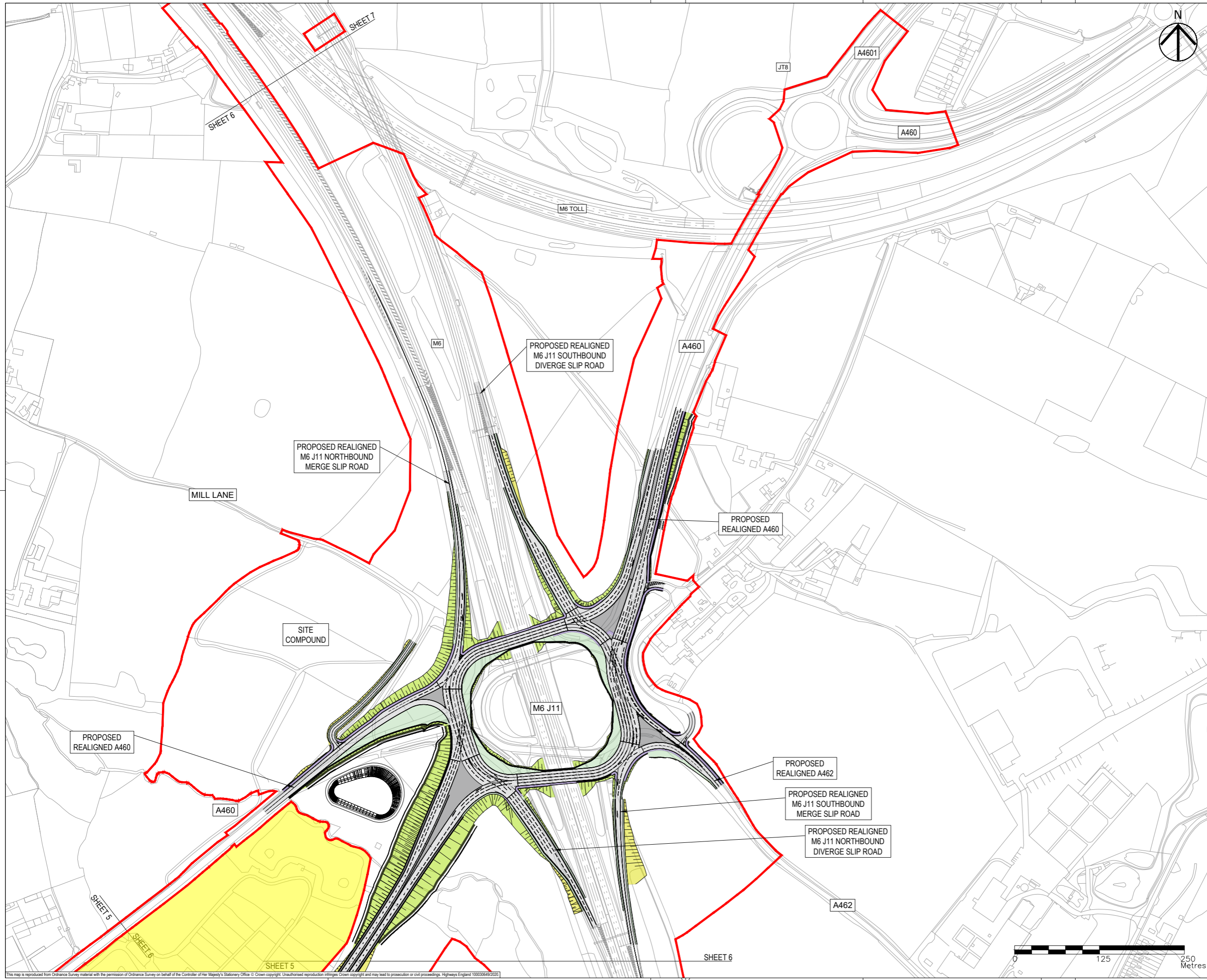

- NOTES**
1. THIS DRAWING IS TO BE READ IN CONJUNCTION WITH ALL OTHER RELEVANT DOCUMENTATION.
  2. DO NOT SCALE FROM THIS DRAWING. USE ONLY PRINTED DIMENSIONS.
  3. ALL DIMENSIONS IN MILLIMETRES. ALL CHAINAGES, LEVELS AND COORDINATES ARE IN METRES UNLESS DEFINED OTHERWISE.
  4. THIS DRAWING IS TO BE READ IN CONJUNCTION WITH THE PROJECT HEALTH & SAFETY FILE FOR ANY IDENTIFIED POTENTIAL RISKS.
- KEY**
- LIMITS OF LAND TO BE ACQUIRED OR USED PERMANENTLY OR TEMPORARILY (THE ORDER LIMITS)
  - LAND NOT INCLUDED WITHIN THE ORDER LIMITS
  - RETAINING WALLS
  - NON-MOTORISED USER ROUTE (PLEASE REFER TO STREETS, RIGHTS OF WAY AND ACCESS PLANS [TR010054/APP/2.7] FOR MORE INFORMATION)
  - EMBANKMENTS
  - CUTTINGS
  - VERGES / GRASSED AREAS

Revision Details	By	Date	Suffix
First Issue in Draft	MW	21/12/18	P01
See Revision Notes for further details	JD	22/02/19	P02
See Revision Notes for further details	MW	29/03/19	P03
See Revision Notes for further details	JP	14/05/19	P04
Refer to Design Change Tracker for details	HS	15/08/19	P05
Refer to Design Change Tracker for details	JP	30/10/19	P06
Background colour added	JP	17/12/19	P07
Minor amendments.	MW	21/01/20	P08
Updated to reflect Oct 2020 scheme changes.	MW	18/09/20	P09
Hatching and key updated.	MW	08/10/20	P10

**DCO APPLICATION**

Client  
 Highways England  
 Floor 5  
 Two Colmore Square  
 38 Colmore Circus  
 Birmingham  
 B4 6BN

Development Consent Order Number  
**TR010054**

Project Title  
**M54 to M6 Link Road**

Development Consent Order Drawing Number  
**TR010054/APP/2.5**

Drawing Title  
**GENERAL ARRANGEMENT  
 REGULATION 5(2)(O)  
 SHEET 6 OF 10**

Designed	Drawn	Checked	Approved	Date
---	MW	AM	RR	08/10/20

Internal Project No. 60536736  
 Scale @ A1 1:2500H/1:2500V  
 Suitability S8  
 Zone Highways General

THIS DOCUMENT HAS BEEN PREPARED PURSUANT TO AND SUBJECT TO THE TERMS OF AECOM'S APPOINTMENT BY ITS CLIENT. AECOM ACCEPTS NO LIABILITY FOR ANY USE OF THIS DOCUMENT OTHER THAN BY ITS ORIGINAL CLIENT OR FOLLOWING AECOM'S EXPRESS AGREEMENT TO SUCH USE, AND ONLY FOR THE PURPOSES FOR WHICH IT WAS PREPARED AND PROVIDED.

Drawing Number  
**HE514465 -ACM -HGN-**  
 Location **Z3 SW\_PR\_Z**  
 I Type I Role I Number

Rev  
**P10**

This map is reproduced from Ordnance Survey material with the permission of Ordnance Survey on behalf of the Controller of Her Majesty's Stationery Office © Crown copyright. Unauthorised reproduction infringes Crown copyright and may lead to prosecution or civil proceedings. Highways England 100030649/2020

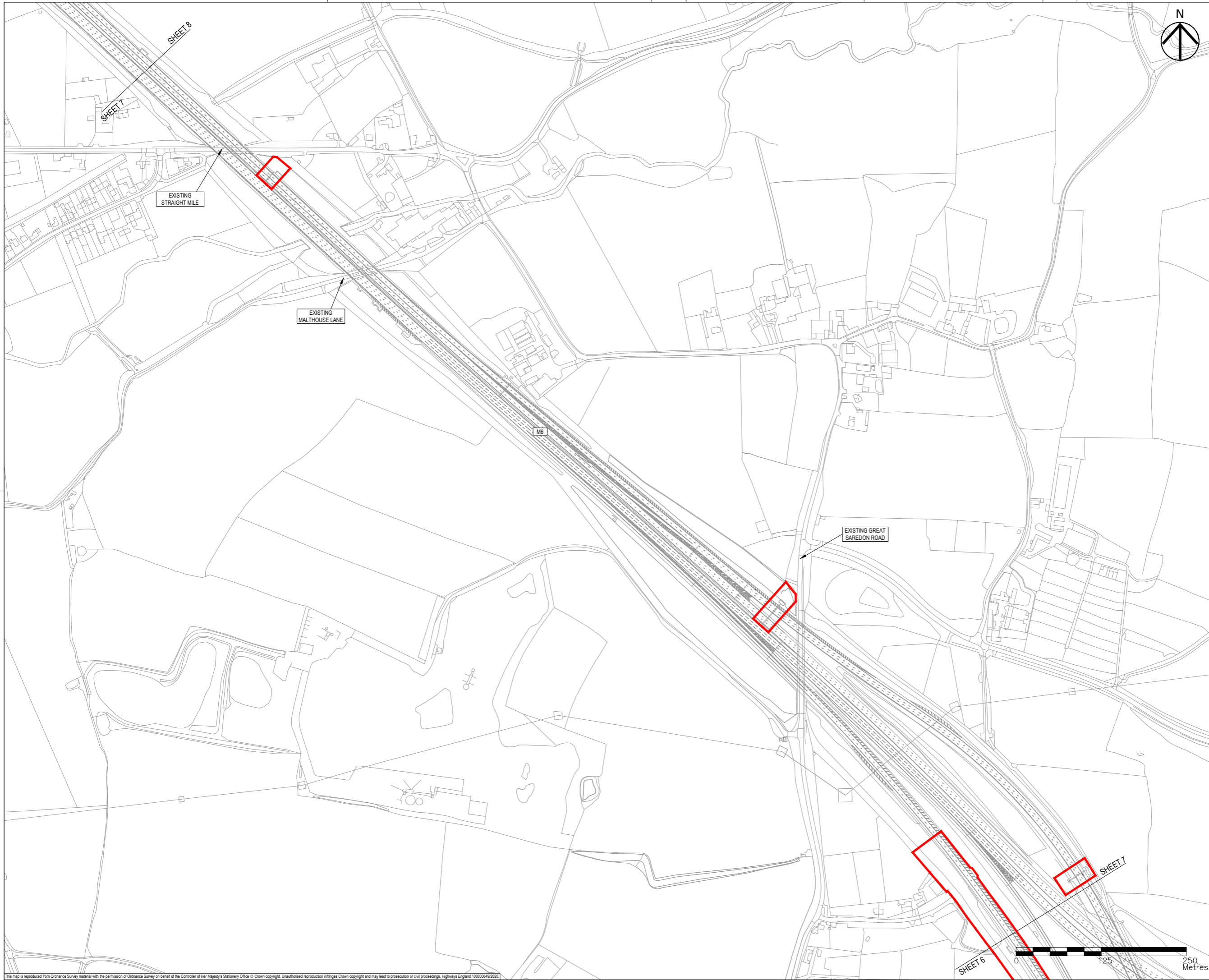

- NOTES**
- THIS DRAWING IS TO BE READ IN CONJUNCTION WITH ALL OTHER RELEVANT DOCUMENTATION.
  - DO NOT SCALE FROM THIS DRAWING. USE ONLY PRINTED DIMENSIONS.
  - ALL DIMENSIONS IN MILLIMETRES. ALL CHAINAGES, LEVELS AND COORDINATES ARE IN METRES UNLESS DEFINED OTHERWISE.
  - THIS DRAWING IS TO BE READ IN CONJUNCTION WITH THE PROJECT HEALTH & SAFETY FILE FOR ANY IDENTIFIED POTENTIAL RISKS.

- KEY**
- LIMITS OF LAND TO BE ACQUIRED OR USED PERMANENTLY OR TEMPORARILY (THE ORDER LIMITS)
  - LAND NOT INCLUDED WITHIN THE ORDER LIMITS
  - RETAINING WALLS
  - NON-MOTORISED USER ROUTE (PLEASE REFER TO STREETS, RIGHTS OF WAY AND ACCESS PLANS [TR010054/APP/2.7] FOR MORE INFORMATION)
  - EMBANKMENTS
  - CUTTINGS
  - VERGES / GRASSED AREAS

Revision Details	By	Check	Date	Suffix
First Issue in Draft	MW	AM	21/12/18	P01
See Revision Notes for further details	JD	AM	22/02/19	P02
See Revision Notes for further details	MW	AM	29/03/19	P03
Road Markings and Hatching Added.	AM	AM	10/05/19	P04
Refer to Design Change Tracker for details	HS	DYT	15/08/19	P05
Refer to Design Change Tracker for details	JP	RR	30/10/19	P06
Background colour added	JP	DL	17/12/19	P07
Minor amendments.	MW	RR	21/01/20	P08
Hatching and key updated.	MW	RR	08/10/20	P09

**DCO APPLICATION**

Client  
**Highways England**  
 Floor 5  
 Two Colmore Square  
 38 Colmore Circus  
 Birmingham  
 B4 6BN

Development Consent Order Number  
**TR010054**

Project Title  
**M54 to M6 Link Road**

Development Consent Order Drawing Number  
**TR010054/APP/2.5**

Drawing Title  
**GENERAL ARRANGEMENT  
 REGULATION 5(2)(O)  
 SHEET 7 OF 10**

Designed	Drawn	Checked	Approved	Date
MW	MW	AM	RR	08/10/20

Internal Project No. 60536736  
 Scale @ A1 1:2500H/1:2500V  
 Suitability S8  
 Zone Highways General

THIS DOCUMENT HAS BEEN PREPARED PURSUANT TO AND SUBJECT TO THE TERMS OF AECOM'S APPOINTMENT BY ITS CLIENT. AECOM ACCEPTS NO LIABILITY FOR ANY USE OF THIS DOCUMENT OTHER THAN BY ITS ORIGINAL CLIENT OR FOLLOWING AECOM'S EXPRESS AGREEMENT TO SUCH USE, AND ONLY FOR THE PURPOSES FOR WHICH IT WAS PREPARED AND PROVIDED.

Drawing Number HE514465	Highways England PIN -ACM	Originator -HGN-	Volume Z3 SW_PR_Z	Rev P09
			DR-CH-1007	

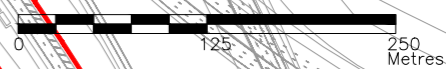

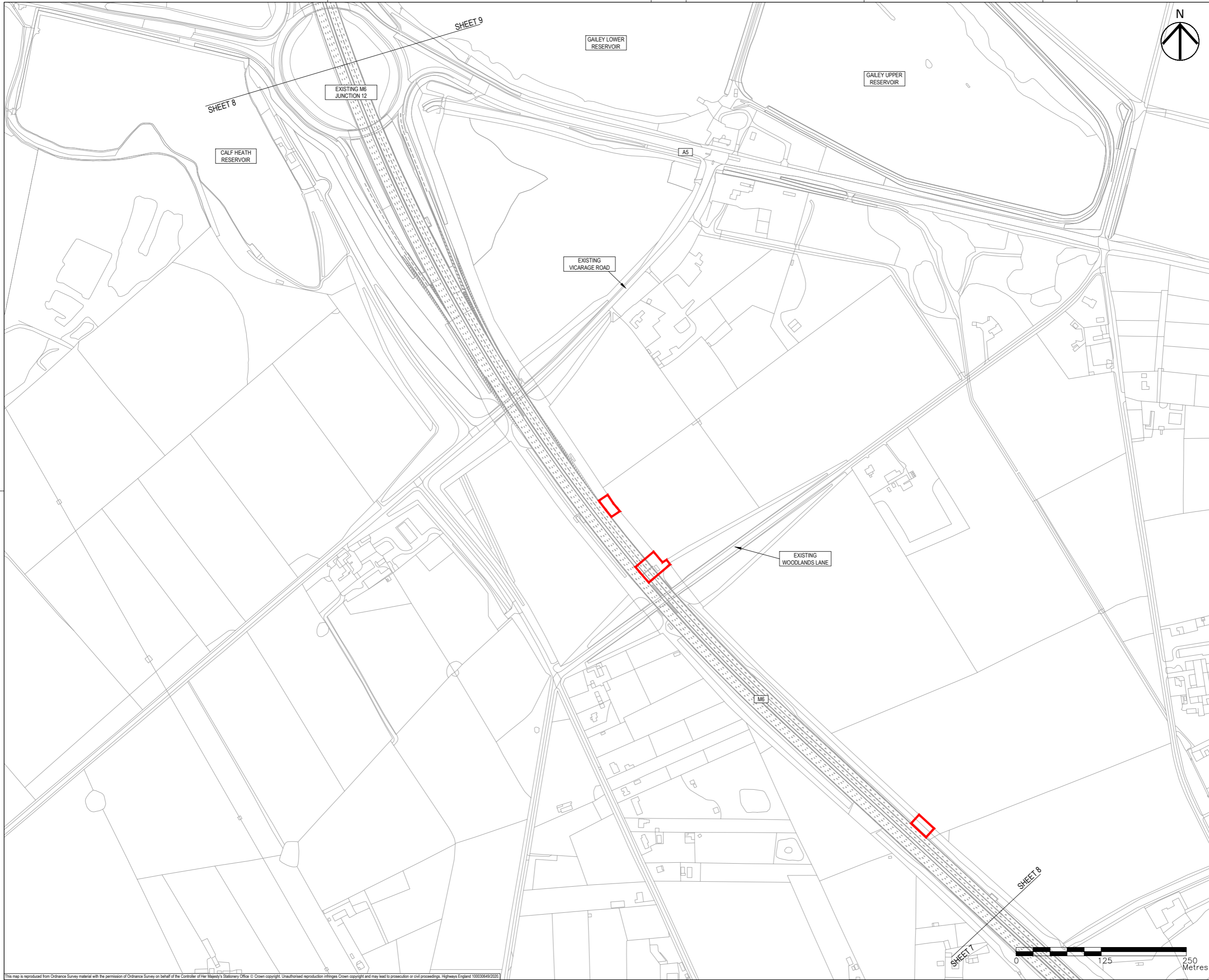

- NOTES**
- THIS DRAWING IS TO BE READ IN CONJUNCTION WITH ALL OTHER RELEVANT DOCUMENTATION.
  - DO NOT SCALE FROM THIS DRAWING. USE ONLY PRINTED DIMENSIONS.
  - ALL DIMENSIONS IN MILLIMETRES. ALL CHAINAGES, LEVELS AND COORDINATES ARE IN METRES UNLESS DEFINED OTHERWISE.
  - THIS DRAWING IS TO BE READ IN CONJUNCTION WITH THE PROJECT HEALTH & SAFETY FILE FOR ANY IDENTIFIED POTENTIAL RISKS.

- KEY**
- LIMITS OF LAND TO BE ACQUIRED OR USED PERMANENTLY OR TEMPORARILY (THE ORDER LIMITS)
  - LAND NOT INCLUDED WITHIN THE ORDER LIMITS
  - RETAINING WALLS
  - NON-MOTORISED USER ROUTE (PLEASE REFER TO STREETS, RIGHTS OF WAY AND ACCESS PLANS [TR010054/APP/2.7] FOR MORE INFORMATION)
  - EMBANKMENTS
  - CUTTINGS
  - VERGES / GRASSED AREAS

Revision Details	By	Check	Date	Suffix
First Issue in Draft	MW	AM	21/12/18	P01
No significant changes noted from previous revision	JD	AM	22/02/19	P02
No significant changes noted from previous revision	MW	AM	29/03/19	P03
Road Markings and Hatching Added.	JP	AM	14/05/19	P04
No significant changes noted from previous revision	HS	DYT	15/08/19	P05
Refer to Design Change Tracker for details	JP	RR	30/10/19	P06
Background colour added	JP	DL	17/12/19	P07
Minor amendments.	MW	RR	21/01/20	P08
Hatching and key updated.	MW	RR	08/10/20	P09

**DCO APPLICATION**

Client  
**Highways England**  
 Floor 5  
 Two Colmore Square  
 38 Colmore Circus  
 Birmingham  
 B4 6BN

Development Consent Order Number  
**TR010054**

Project Title  
**M54 to M6 Link Road**



Development Consent Order Drawing Number  
**TR010054/APP/2.5**

Drawing Title  
**GENERAL ARRANGEMENT  
 REGULATION 5(2)(O)  
 SHEET 8 OF 10**

Designed	Drawn	Checked	Approved	Date
---	MW	AM	RR	08/10/20

Internal Project No. 60536736  
 Scale @ A1 1:2500H/1:2500V  
 Suitability S8  
 Zone Highways General

THIS DOCUMENT HAS BEEN PREPARED PURSUANT TO AND SUBJECT TO THE TERMS OF AECOM'S APPOINTMENT BY ITS CLIENT. AECOM ACCEPTS NO LIABILITY FOR ANY USE OF THIS DOCUMENT OTHER THAN BY ITS ORIGINAL CLIENT OR FOLLOWING AECOM'S EXPRESS AGREEMENT TO SUCH USE, AND ONLY FOR THE PURPOSES FOR WHICH IT WAS PREPARED AND PROVIDED.

Drawing Number  
**HE514465 -ACM -HGN-**  
**Z3 SW\_PR\_Z -DR-CH-1008**

Revision  
**P09**

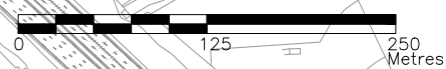

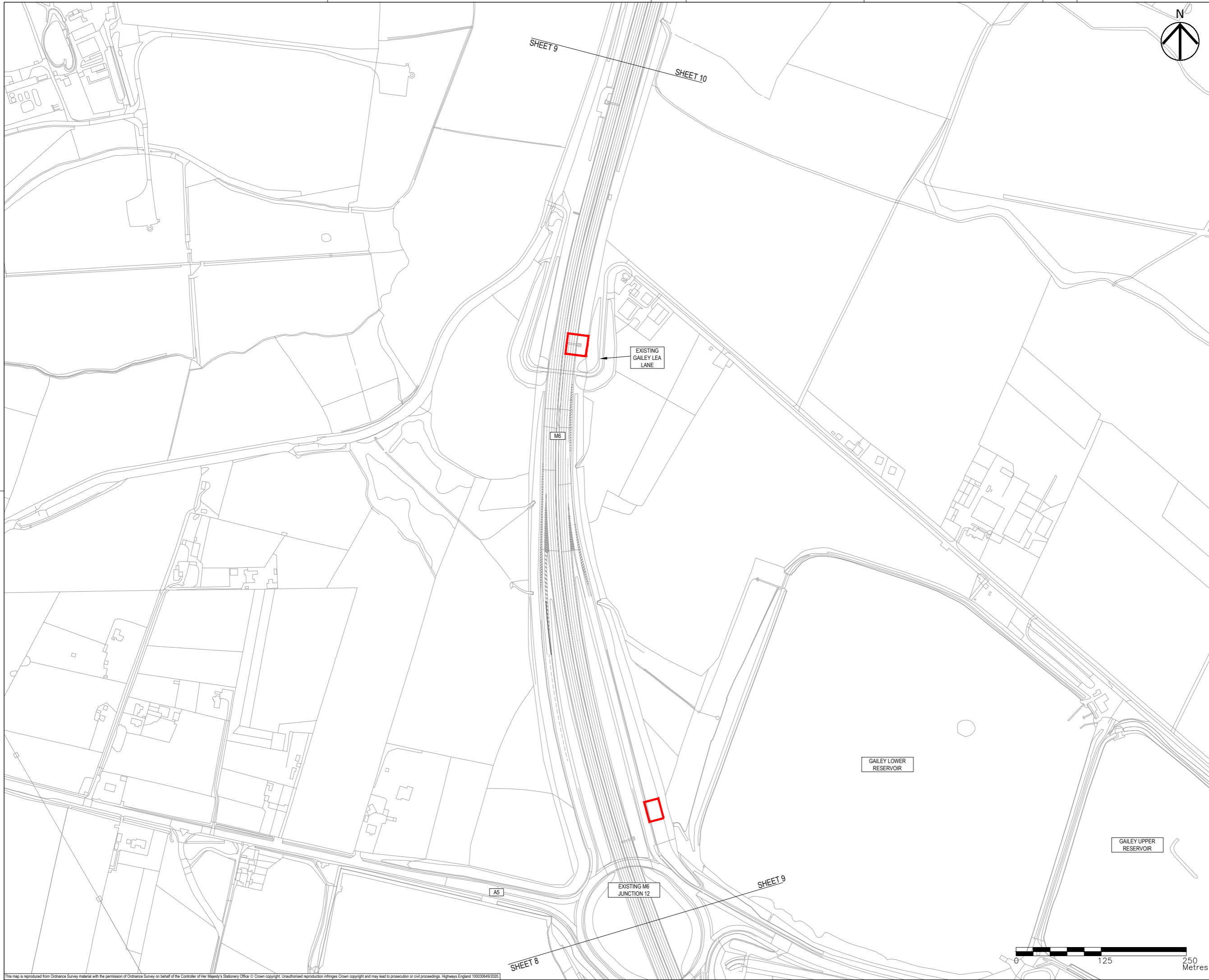

- NOTES**
1. THIS DRAWING IS TO BE READ IN CONJUNCTION WITH ALL OTHER RELEVANT DOCUMENTATION.
  2. DO NOT SCALE FROM THIS DRAWING. USE ONLY PRINTED DIMENSIONS.
  3. ALL DIMENSIONS IN MILLIMETRES. ALL CHAINAGES, LEVELS AND COORDINATES ARE IN METRES UNLESS DEFINED OTHERWISE.
  4. THIS DRAWING IS TO BE READ IN CONJUNCTION WITH THE PROJECT HEALTH & SAFETY FILE FOR ANY IDENTIFIED POTENTIAL RISKS.

- KEY**
- LIMITS OF LAND TO BE ACQUIRED OR USED PERMANENTLY OR TEMPORARILY (THE ORDER LIMITS)
  - LAND NOT INCLUDED WITHIN THE ORDER LIMITS
  - RETAINING WALLS
  - NON-MOTORISED USER ROUTE (PLEASE REFER TO STREETS, RIGHTS OF WAY AND ACCESS PLANS [TR010054/APP/2.7] FOR MORE INFORMATION)
  - EMBANKMENTS
  - CUTTINGS
  - VERGES / GRASSED AREAS

Revision Details	By	Date	Suffix
First Issue in Draft	MW	21/12/18	P01
No significant changes noted from previous revision	JD	22/02/19	P02
No significant changes noted from previous revision	MW	29/03/19	P03
No significant changes noted from previous revision	JP	14/05/19	P04
No significant changes noted from previous revision	HS	15/08/19	P05
Refer to Design Change Tracker for details	JP	30/10/19	P06
Background colour added	JP	17/12/19	P07
Minor amendments.	MW	21/01/20	P08
Hatching and key updated.	MW	08/10/20	P09

**DCO APPLICATION**

Client  
**Highways England**  
 Floor 5  
 Two Colmore Square  
 38 Colmore Circus  
 Birmingham  
 B4 6BN

Development Consent Order Number  
**TR010054**

Project Title  
**M54 to M6 Link Road**

Development Consent Order Drawing Number  
**TR010054/APP/2.5**

Drawing Title  
**GENERAL ARRANGEMENT  
 REGULATION 5(2)(O)  
 SHEET 9 OF 10**

Designed	Drawn	Checked	Approved	Date
MW	MW	AM	RR	08/10/20

Internal Project No. 60536736  
 Scale @ A1 1:2500H/1:2500V  
 Suitability S8  
 Zone Highways General

THIS DOCUMENT HAS BEEN PREPARED PURSUANT TO AND SUBJECT TO THE TERMS OF AECOM'S APPOINTMENT BY ITS CLIENT. AECOM ACCEPTS NO LIABILITY FOR ANY USE OF THIS DOCUMENT OTHER THAN BY ITS ORIGINAL CLIENT OR FOLLOWING AECOM'S EXPRESS AGREEMENT TO SUCH USE, AND ONLY FOR THE PURPOSES FOR WHICH IT WAS PREPARED AND PROVIDED.







Drawing Number HE514465 -ACM -HGN-	Highways England PIN	Originator	Volume	Rev
Z3 SW_PR_Z			DR-CH-1009	P09
Location	Type	Role	Number	



NOTES

1. THIS DRAWING IS TO BE READ IN CONJUNCTION WITH ALL OTHER RELEVANT DOCUMENTATION.
2. DO NOT SCALE FROM THIS DRAWING. USE ONLY PRINTED DIMENSIONS.
3. ALL DIMENSIONS IN MILLIMETRES. ALL CHAINAGES, LEVELS AND COORDINATES ARE IN METRES UNLESS DEFINED OTHERWISE.
4. THIS DRAWING IS TO BE READ IN CONJUNCTION WITH THE PROJECT HEALTH & SAFETY FILE FOR ANY IDENTIFIED POTENTIAL RISKS.

KEY

-  LIMITS OF LAND TO BE ACQUIRED OR USED PERMANENTLY OR TEMPORARILY (THE ORDER LIMITS)
-  LAND NOT INCLUDED WITHIN THE ORDER LIMITS
-  RETAINING WALLS
-  NON-MOTORISED USER ROUTE (PLEASE REFER TO STREETS, RIGHTS OF WAY AND ACCESS PLANS [TR010054/APP/2.7] FOR MORE INFORMATION)
-  EMBANKMENTS
-  CUTTINGS
-  VERGES / GRASSED AREAS

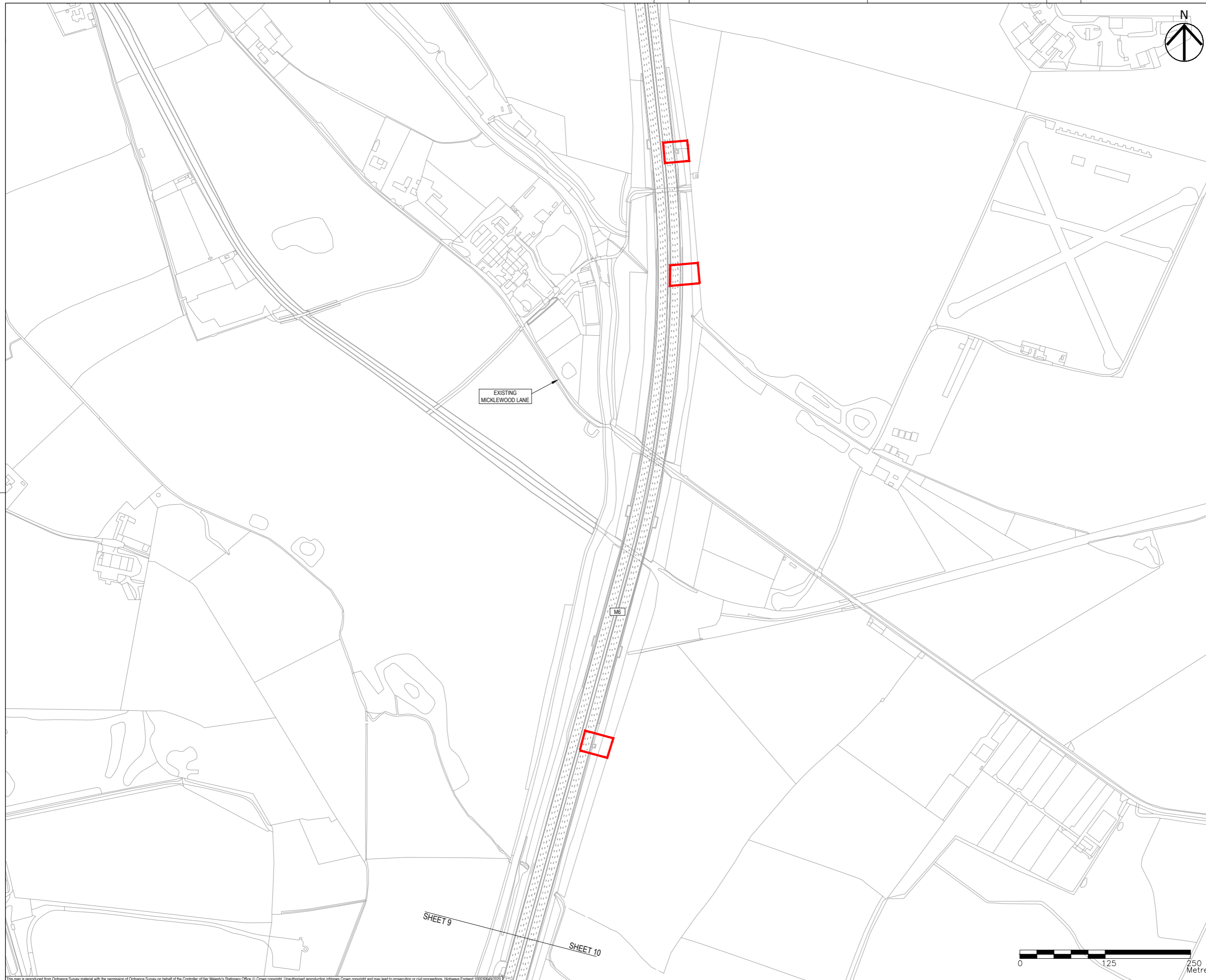

First Issue in Draft	MW	AM	21/12/18	P01
No significant changes noted from previous revision	JD	AM	22/02/19	P02
No significant changes noted from previous revision	MW	AM	29/03/19	P03
No significant changes noted from previous revision	JP	AM	14/05/19	P04
No significant changes noted from previous revision	HS	DYT	15/08/19	P05
Refer to Design Change Tracker for details	JP	RR	30/10/19	P06
Background colour added	JP	DL	17/12/19	P07
Minor amendments.	MW	RR	21/01/20	P08
Hatching and key updated.	MW	RR	08/10/20	P09
Revision Details	By	Check	Date	Suffix

DCO APPLICATION

Client  
**Highways England**  
 Floor 5  
 Two Colmore Square  
 38 Colmore Circus  
 Birmingham  
 B4 6BN



Development Consent Order Number  
**TR010054**

Project Title  
**M54 to M6 Link Road**

Development Consent Order Drawing Number  
**TR010054/APP/2.5**

Drawing Title  
**GENERAL ARRANGEMENT  
 REGULATION 5(2)(O)  
 SHEET 10 OF 10**

Designed MW	Drawn MW	Checked AM	Approved RR	Date 08/10/20
Internal Project No. 60536736			Suitability S8	
Scale @ A1 1:2500H/1:2500V			Zone Highways General	

THIS DOCUMENT HAS BEEN PREPARED PURSUANT TO AND SUBJECT TO THE TERMS OF AECOM'S APPOINTMENT BY ITS CLIENT. AECOM ACCEPTS NO LIABILITY FOR ANY USE OF THIS DOCUMENT OTHER THAN BY ITS ORIGINAL CLIENT OR FOLLOWING AECOM'S EXPRESS AGREEMENT TO SUCH USE, AND ONLY FOR THE PURPOSES FOR WHICH IT WAS PREPARED AND PROVIDED.

Drawing Number HE514465	Highways England PIN -ACM	Originator -HGN-	Volume -DR-CH-1010	Rev P09
Location Z3 SW_PR_Z	Type I	Role I	Number I	